

# SPM Series

## SMT Power Metal Inductor

### Size 2010

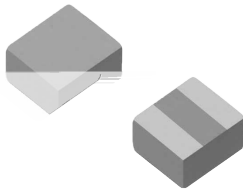

#### CHARACTERISTICS

- Large current, Low DC-resistance, High efficiency by magnetic metal powder
- Low acoustic noise and low leakage flux noise by shielded construction
- Operating temperature: -40°C ~125°C
- Quantity: 3000 pcs/reel
- AEC-Q200 qualified

#### Dimensions: [mm]

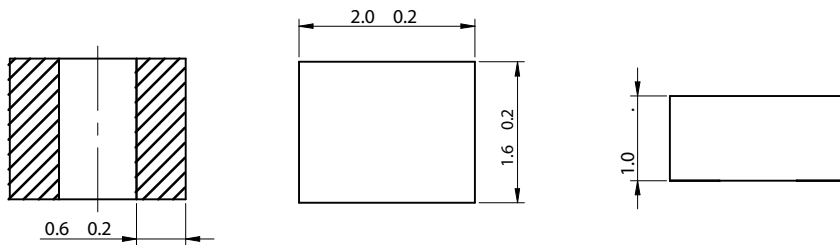

#### Land Pattern: [mm]

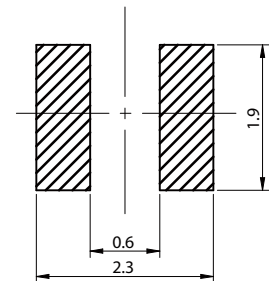

#### Electrical Properties:

Part No	Inductance =	Tolerance	Temperature Rise Current Max.	Current Max.	DCR Max.	DCR Typ.
SPM2010-R33N	0.33	± 30%	2.50	4.50	53	40
SPM2010-R47N	0.47	± 30%	2.30	4.40	63	49
SPM2010-R56N	0.56	± 30%	2.10	4.10	73	56
SPM2010-R68N	0.68	± 30%	2.00	4.00	84	65
SPM2010-R82N	0.82	± 30%	1.90	3.30	92	71
SPM2010-1R0M	1.0	± 20%	1.80	3.20	104	86
SPM2010-1R2M	1.2	± 20%	1.50	2.90	136	114
SPM2010-1R5M	1.5	± 20%	1.30	2.50	180	150
SPM2010-2R2M	2.2	± 20%	1.10	1.90	270	225

Temperature rise current: the actual value of DC current when the temperature rise is T40C  
 Saturation Current that will cause initial inductance to drop approximately 20%



# Typical Electrical Characteristics:

