

## MI Series

### CHARACTERISTICS

- Monolithic structure with mul layer
- Wide inductance range
- Small size and low profile available
- Quan ty: 3000pcs

### APPLICATION

- Noise suppression
- Filters

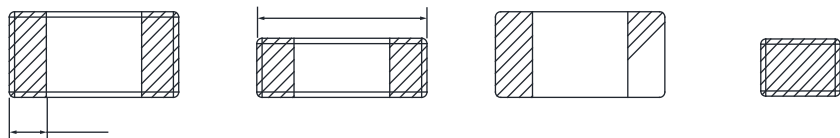

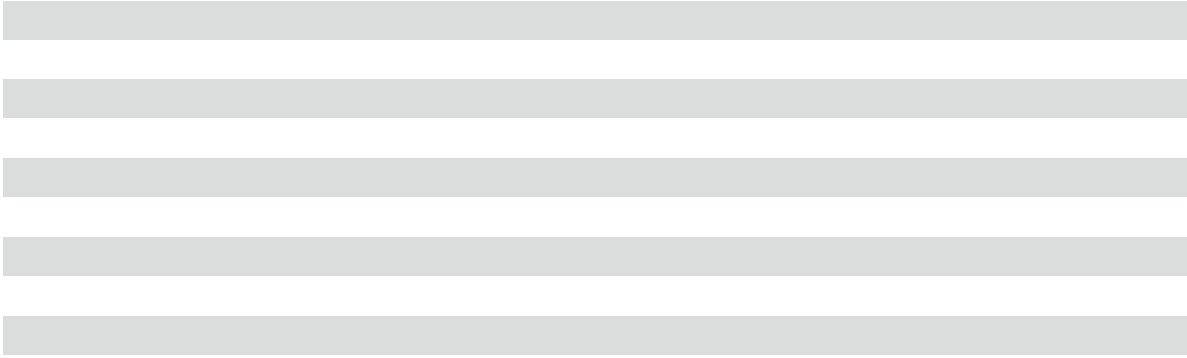

INDUCTANCE( $\mu$ H)

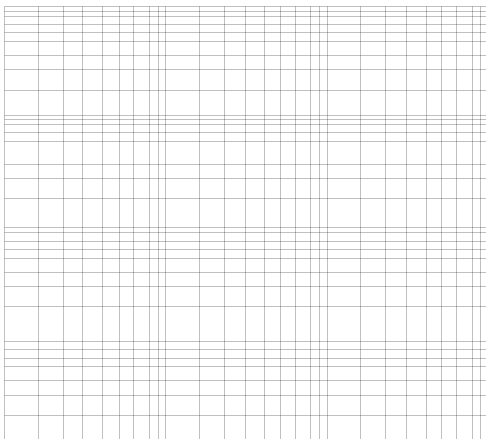

DC CURRENT(mA)

IMPEDANCE(K )

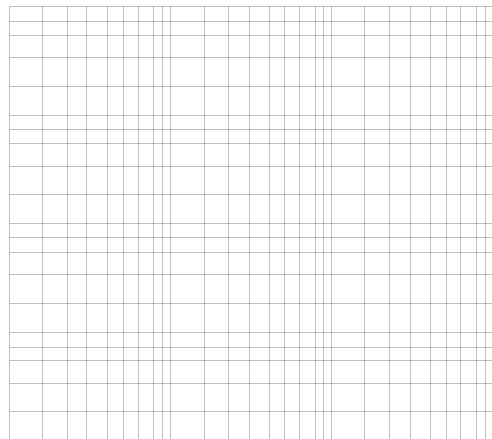

FREQUENCY(MHz)