

FHC Series

CHARACTERISTICS

-
-
-
- Quantity: 400pcs
- Magnetic shielded structure

APPLICATION

-
- High current DC/DC converter
- LC filter

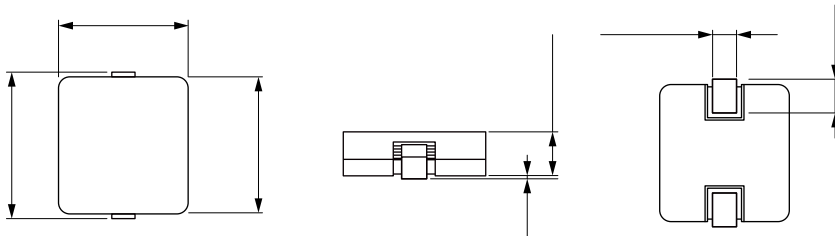

Operating Temperature : -40 °C to +125 °C

Temperature Rise Current: the actual value of DC current when the temperature rise is $\geq 50^{\circ}\text{C}$

Saturation Current that will cause initial inductance to drop approximately 30%

